

THIS DRAWING AND THE SUBJECT MATTER SHOWN THEREON ARE CONFIDENTIAL AND THE PROPERTY OF BEL/STEWART/TRP CONNECTOR AND SHALL NOT BE REPRODUCED, COPIED, OR USED IN ANY MANNER WITHOUT THE WRITTEN CONSENT OF TRP CONNECTOR.

PRODUCT MAY BE PROTECTED BY ONE OR MORE OF THE FOLLOWING US PATENTS:  
 5736910 5939955 6425781 6428361 6554638 6840817 7123117  
 7429195 7717749 7808751 6217391 6149050 7924130

REVISIONS				
P	LTR	DESCRIPTION	DATE	APVD
A		EC-2510006	16OCT2025	QL TY

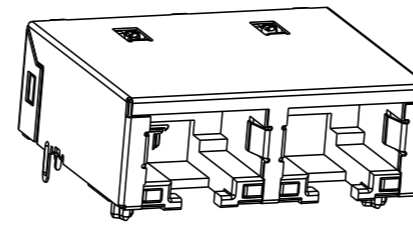
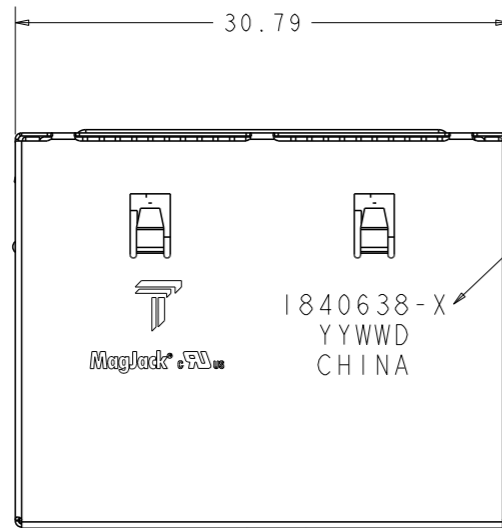

SCALE 2:1

- MATERIALS:  
 HOUSING: THERMOPLASTIC, BLACK, FLAMMABILITY RATING UL 94V-0  
 SHIELD: BRASS, THICKNESS = 0.2mm, PREPLATED WITH MIN 0.76  $\mu$ m SEMI-BRIGHT NICKEL, POST DIPPED WITH 2.54  $\mu$ m MIN LEAD FREE SOLDER AT GROUND PINS  
 CONTACT: PHOSPHOR BRONZE, 0.25mm THICK, 0.46mm WIDE, PREPLATED WITH 1.27 $\mu$ m MIN NICKEL OVERALL UNDERPLATE AND SELECTIVE 1.27  $\mu$ m MIN GOLD PLATED ON MATING INTERFACE  
 CONTACT TAIL: PHOSPHOR BRONZE, 0.3mm THICK, WITH 1.27 $\mu$ m MIN NICKEL OVERALL UNDERPLATE AND 2.54  $\mu$ m MIN MATTE TIN OVERALL PLATED  
 LIGHT PIPE: POLYETHER SULFONE, TRANSPARENT, RATING UL 94V-0
- MAGNETIC:  
 APPLICATIONS: 10/100/1000 BASE-T, EXTENDED TEMPERATURE  
 IMPEDANCE: 100 OHMS  
 TURNS RATIO (CHIP:CABLE): 1:1 ALL 4 PAIRS  
 OPEN CIRCUIT INDUCTANCE(OCL): 350  $\mu$ H MIN @ 100kHz, 0.1VRMS 8mA DC BIAS, FROM -40°C TO 85°C. ALL 4 PAIRS

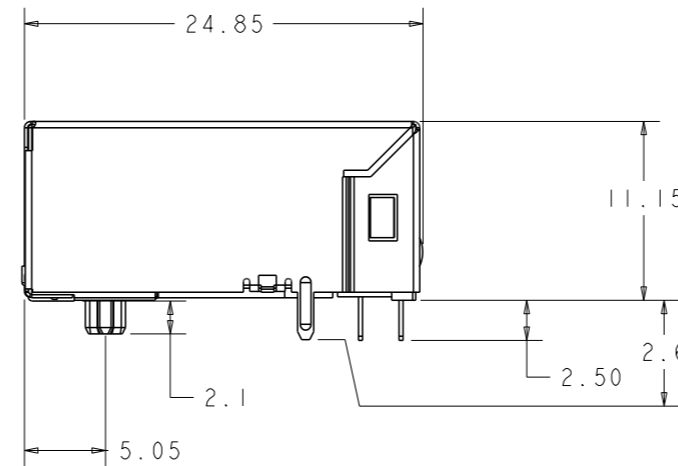
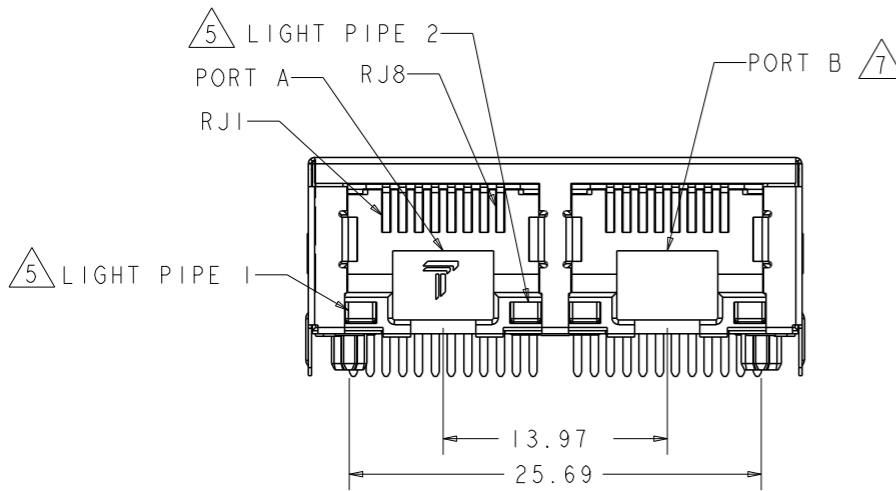

- ALL 4 PAIRS ARE BI-DIRECTIONAL.  
 PERFORMANCE @ 25 °C:  
 INSERTION LOSS(IL): 1.1dB MAX FROM 0.5M Hz TO 100M Hz.  
 RETURN LOSS(RL): 18dB MIN FROM 0.5MHz TO 40MHz.  
 12-20LOG(f/80) MIN FROM 40.1MHz TO 100MHz.  
 CROSS TALK ATTENUATION : 35 dB MIN FROM 0.5MHz TO 40MHz.  
 33- 20LOG(f/50)dB MIN FORM 40.1MHz TO 100MHz.  
 COMMON MODE REJECTION RATIO (CMRR): 30dB MIN FROM 0.5MHz TO 100 MHz  
 ISOLATION VOLTAGE:  
 2250VDC ( MAX) FOR 60 SECONDS WITH A RISE TIME OF 500V/SEC AND WITH ALL PORTS CONNECTED
- THE MAGNETIC CIRCUIT IS SYMMETRICAL AND SUPPORTS AUTO-MDIX OPERATION.
  - OPERATING TEMPERATURE: FROM -40°C TO 85°C.
  - LIGHT PIPES PROVIDED TO GUIDE LIGHT FROM SURFACE MOUNT LEDS LOCATED ON CUSTOMER PC BOARD.
  - ALL DIMENSIONS ARE NOMINAL UNLESS OTHERWISE NOTED.
  - RJ45 CAVITY CONFORMS TO FCC RULES AND REGULATIONS PART 68 SUBPART F.
  - TRP CONNECTOR LOGO, PART NO., DATE CODE, COUNTRY OF ORIGIN ARE TO BE MARKED AT APPROXIMATE LOCATION. DATE CODE: "YY" IS YEAR, "WW" IS WORK WEEK, "D" IS DAY OF WEEK, WITH SUNDAY=1
  - RECOMMENDED LED HEIGHT IS NOT MORE THAN 1.13 MM.EACH LED SHOULD BE SYMMETRICALLY DISTRIBUTED ALONG THE CENTERLINE OF LIGHTPIPE. MAKE SURE LEDS ARE OPTIMALLY POSITIONED NEAR THE LIGHTPIPES. LED POSITION THAT DOES NOT FOLLOW THE RECOMMENDED POSITION MAY CAUSE MECHANICAL INTERFERENCE BETWEEN LED AND LIGHTPIPE OR IT MAY DEGRADE ILLUMINATION THROUGH THE LIGHTPIPE.
  - THE PART IS COMPLIANT WITH BOTH WAVE SOLDERING PROCESS, PREHEAT TEMPERATURE IS 150°C ABOVE, 120 SECONDS TO 180 SECONDS, PEAK SOLDERING TEMPERATURE IS 265°C MAX, 10 SECONDS MAX; AND IR REFLOW SOLDERING PROESS, PEAK SOLDERING TEMPERATURE 260°C MAX DURATION TIME 10 SECONDS MAX, OVER 230°C WITHIN 40-60 SECONDS.

8G41ET GIGABIT CIRCUIT

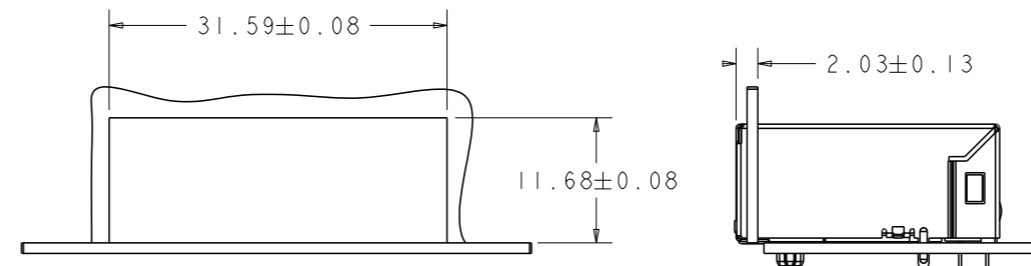
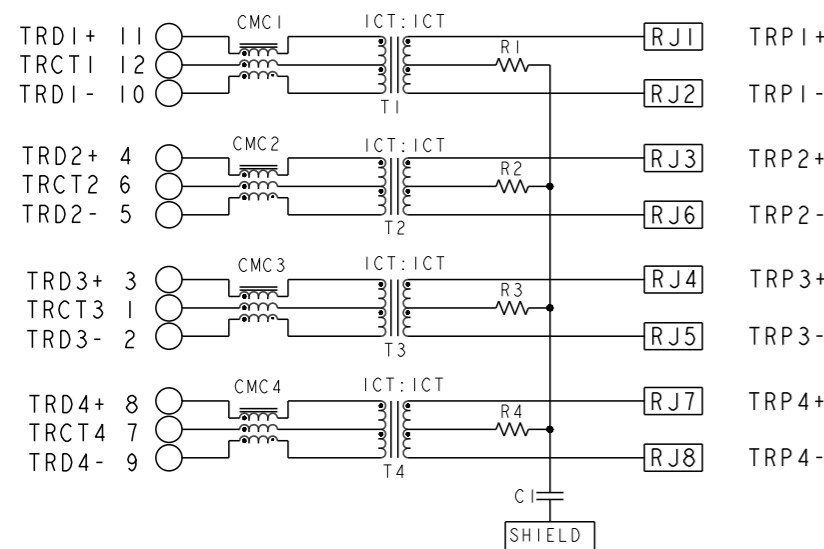

SUGGESTED PANEL OPENING  
SCALE 2:1

C1=1000 pF, 3kV, DECOUPLING CAP  
 R1-R4=75 OHM, RESISTOR

THIS DRAWING IS A CONTROLLED DOCUMENT AND COMPLIANT TO ASME Y14.5M		DWN PAUL P/FRANK L 27MAR2012	<b>trp</b> CONNECTOR a bel group DONGGUAN CHINA
DIMENSIONS: mm		CHK QUENTIN LIU 27MAR2012	
TOLERANCES UNLESS OTHERWISE SPECIFIED:		APVD KEITH ZHU 27MAR2012	
0 PLC ± 1 PLC ±0.25 2 PLC ±0.25 3 PLC ±0.25 4 PLC ± ANGLES ± APPLICATION SPEC		MODEL NAME	
PRODUCT SPEC		MAGJACK GANG NON-POE	DESC 1X2 8G41ET GIGABIT TAB DOWN LOW PROFILE NO LED W/ LIGHTPIPE
		SIZE A2	RESTRICTED TO
		CAGE CODE	DRAWING NO C-1840638
		CUSTOMER DRAWING	SCALE 3:1 SHEET 1 OF 2 REV A

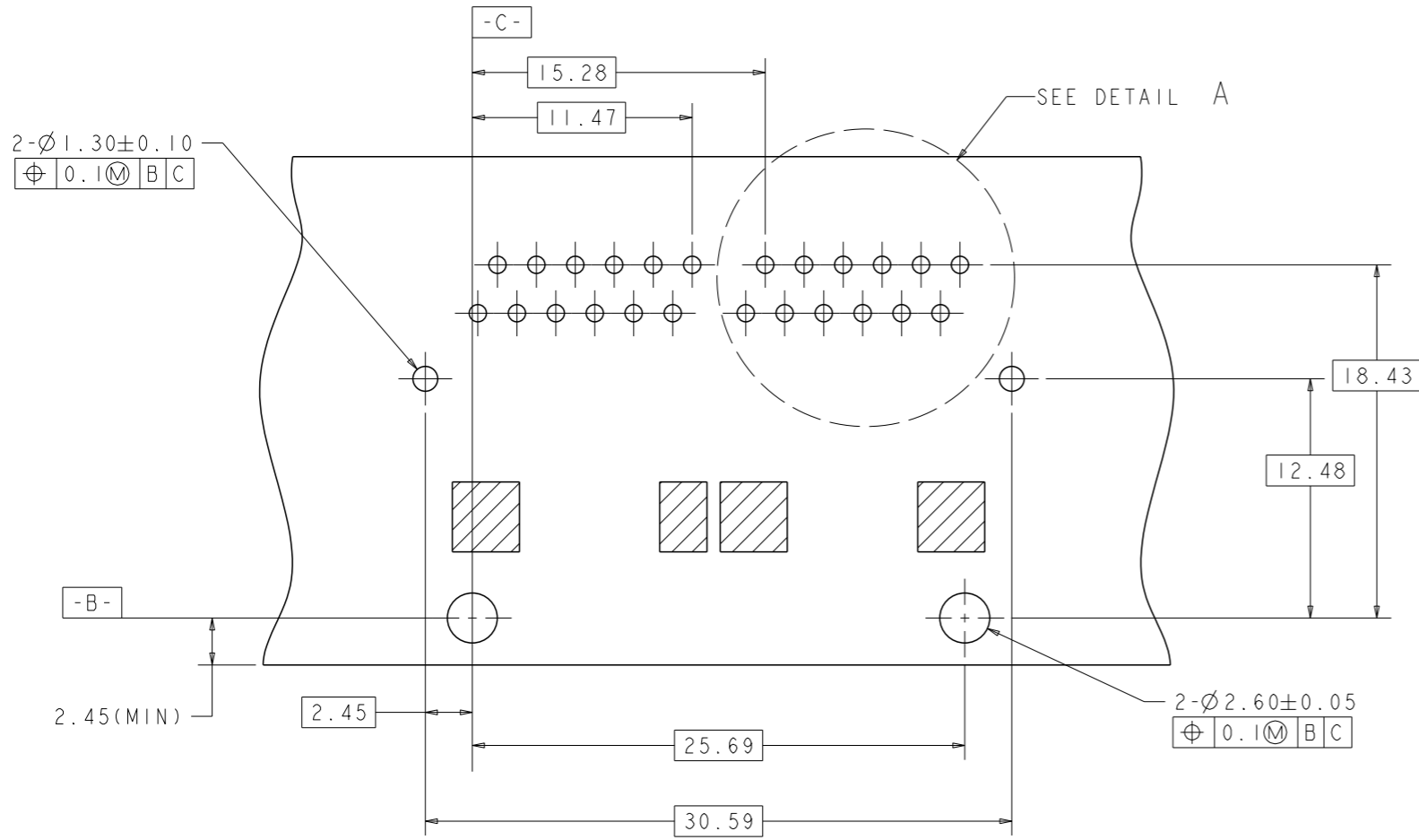

RECOMMENDED PCB LAYOUT  
COMPONENT SIDE

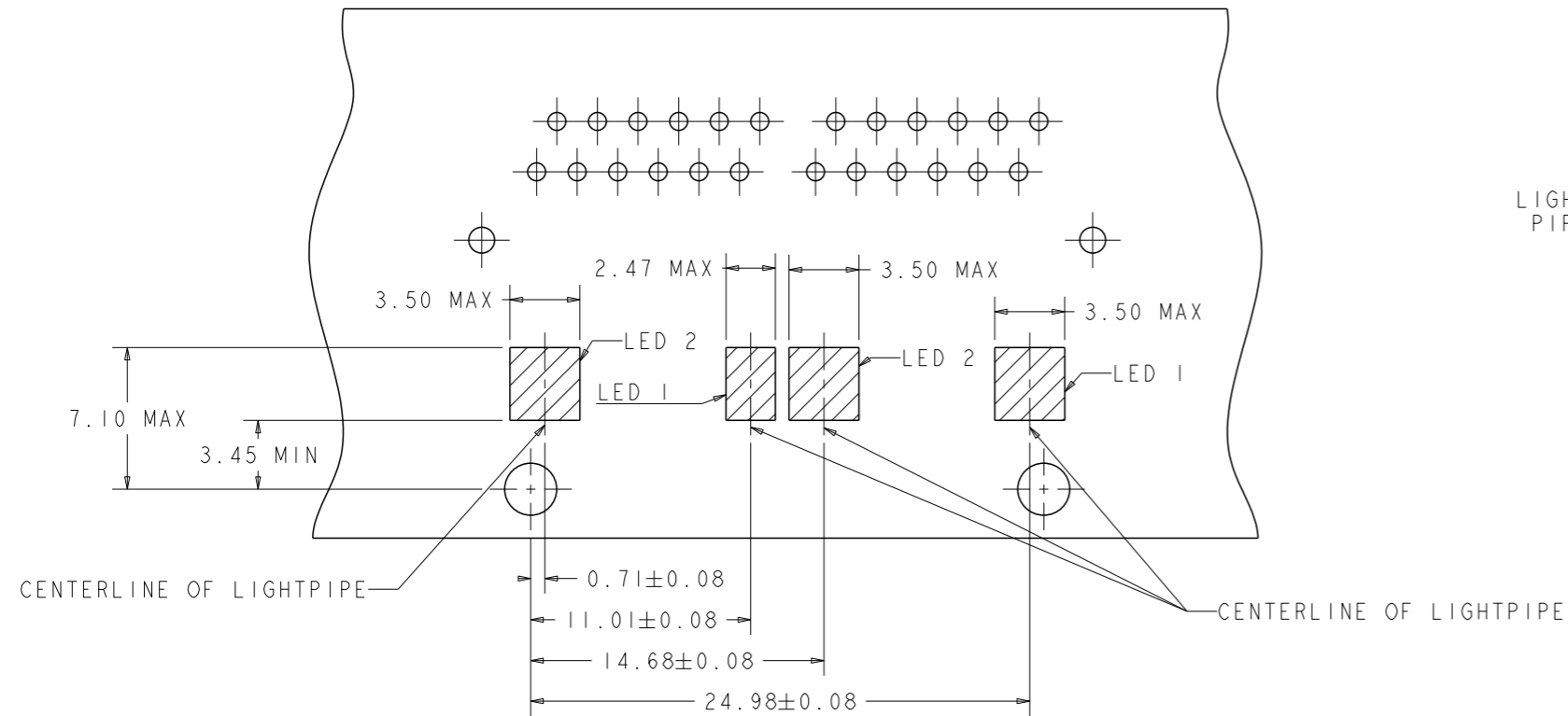

RECOMMENDED LED PACKAGE POSITION   
COMPONENT SIDE

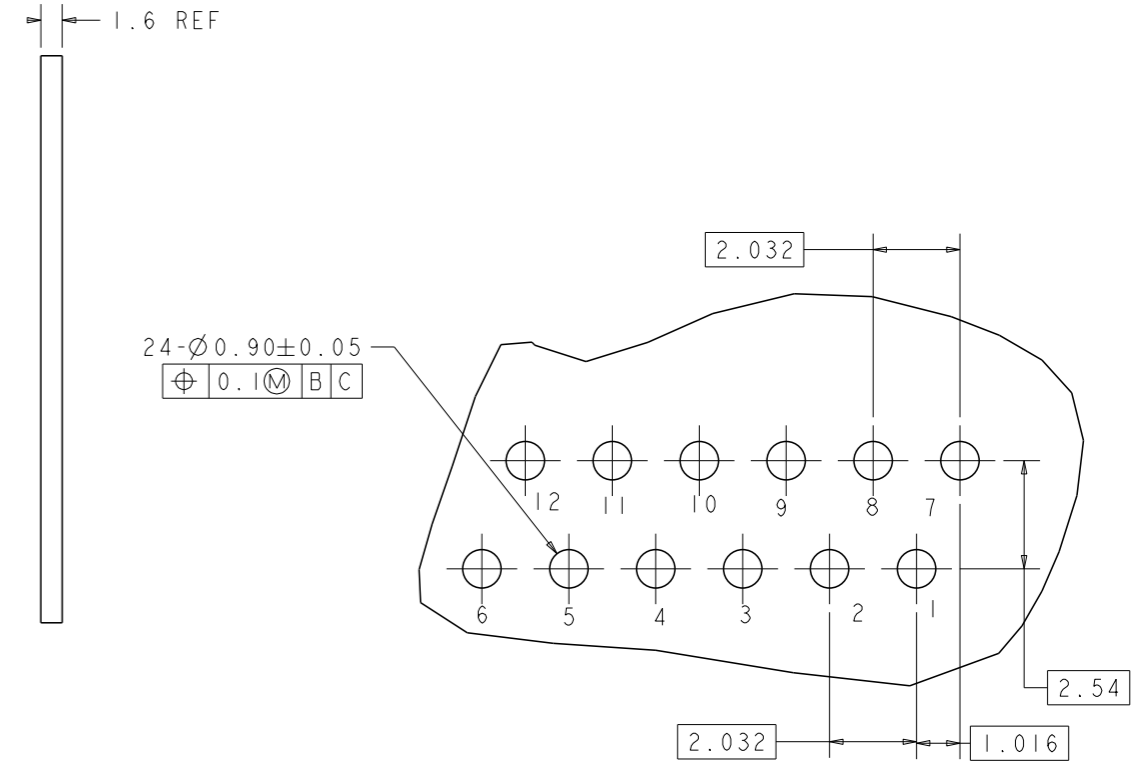

DETAIL A  
SCALE 8:1

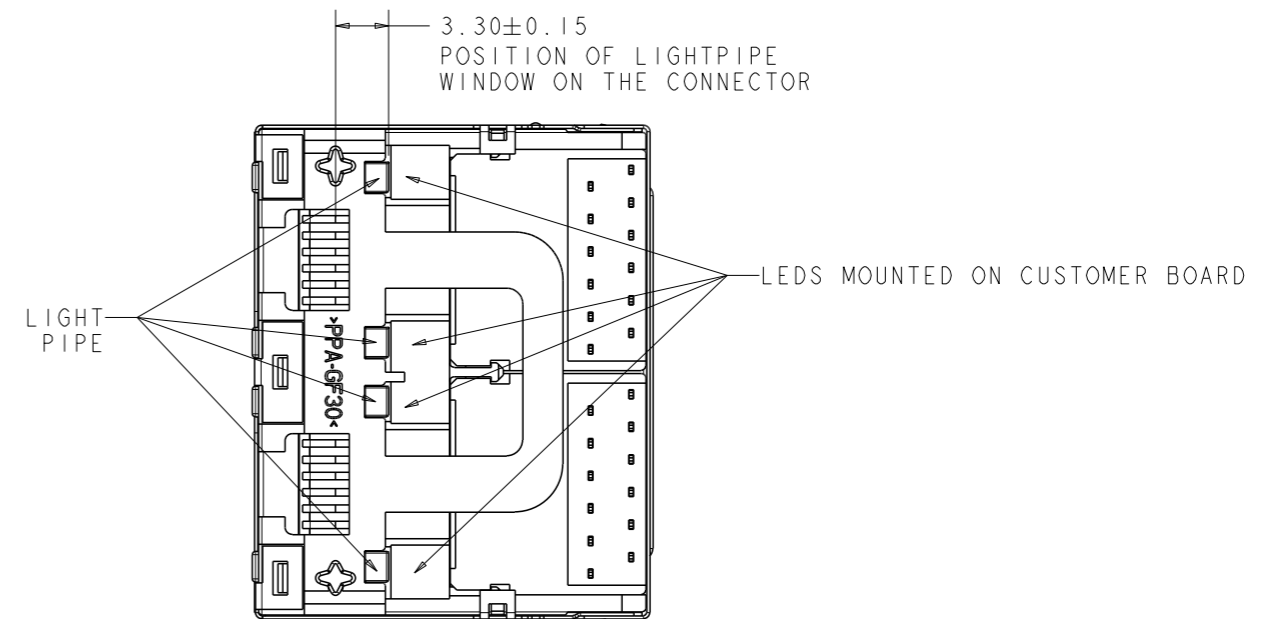

BOTTOM VIEW

THIS DRAWING IS A CONTROLLED DOCUMENT. AND COMPLIANT TO ASME Y14.5M		DWN PAUL P/FRANK L 27MAR2012		DONGGUAN CHINA
DIMENSIONS: mm		CHK QUENTIN LIU 27MAR2012		
TOLERANCES UNLESS OTHERWISE SPECIFIED:		APVD KEITH ZHU 27MAR2012	DESC 1X2 8G41ET GIGABIT TAB DOWN LOW PROFILE NO LED W/ LIGHTPIPE	
0 PLC ± 1 PLC ±0.25 2 PLC ±0.25 3 PLC ±0.25 4 PLC ± ANGLES ± APPLICATION SPEC		MODEL NAME MAGJACK GANG NON-POE	SIZE A2	RESTRICTED TO -
PRODUCT SPEC -		DRAWING NO C-1840638		SCALE 3:1
CUSTOMER DRAWING			SHEET 2 OF 2	REV A