

NOTES:

- SPECIFICATIONS:
 ELECTRICAL:
 WITHSTANDING VOLTAGE: MINIMUM 1250 V RMS @ SEA LEVEL
 INSULATION RESISTANCE: INITIAL 5000 MEGOHMS MAXIMUM,
 1000 MEGOHMS MIN. AFTER ENVIRONMENTAL TESTING.
 CONTACT RATING: 5 AMPS
 CONTACT RESISTANCE: 2.7 MILLIOHMS MAX.
 MATERIALS:
 INSULATOR: WHITE UL94V-0 RATED GLASS FILLED POLYESTER
 CONTACT: COPPER ALLOY
 CONTACT AREA PLATING: GOLD OVER NICKEL,
 CONNECTOR SHELL: STEEL, PLATING ZINC WITH CLEAR CHROMATE.
 ENVIRONMENTAL:
 OPERATING TEMPERATURE: -65°C TO +125°C
 TERMINATION:
 2. TERMINALS ARE INTENDED (BECAUSE OF THE FLOAT) TO BE HAND HAND
 WIRE WRAPPED ONLY. WIRE WRAP # 28 & 30 AWG WIRE.
 3. DIMENSIONS IN [] ARE IN MILLIMETERS.

DRAWING REVISIONS			
REV	DOCUMENT	APP	DATE
A	DO 05-1094	AKB	01/07/06
B	ECN 06E425		

NUMBER OF POSITIONS	SELECTIVE GOLD FLASH PLATING (.120" [3.05] MTG. HOLES)		WIRE WRAP TAIL LENGTH	DIMENSION									FRONT MOUNTING HOLE DIMENSIONS		REAR MOUNTING HOLE DIMENSIONS	
	PART NO.	FACTORY NO.		"A"	"B"	"C"	"D"	"E"	"F"	"G"	"H"	"J"	"X"	"Y"	"X"	"Y"
9	DEH-9P-F179	702 01 09 030	.375 [9.52]	1.213 [30.81]	.984 [24.99]	.697 [17.70]	.360 [9.14]	.759 [19.28]	.422 [10.72]	.045 [1.14]	.030 [.76]	.874 [22.20]	.513 [13.03]	.806 [20.47]	.449 [11.40]	
	DEH-9P-F179C	702 01 09 050	585 [.14.86]	1.541 [39.14]	1.312 [33.32]	1.025 [26.03]										1.083 [27.51]
15	DAH-15P-F179	702 01 15 030	.375 [9.52]	1.541 [39.14]	1.312 [33.32]	1.025 [26.03]	.378 [9.60]	.494 [12.55]	.422 [10.72]	.045 [1.14]	.030 [.76]	1.202 [30.53]	.513 [13.03]	1.134 [28.80]	.449 [11.40]	
	DAH-15P-F179C	702 01 15 050	585 [.14.86]	2.088 [53.04]	1.852 [47.04]	1.583 [40.21]										1.629 [41.38]
25	DBH-25P-F179	702 01 25 030	.375 [9.52]	2.088 [53.04]	1.852 [47.04]	1.583 [40.21]	.378 [9.60]	.494 [12.55]	.422 [10.72]	.045 [1.14]	.030 [.76]	1.743 [44.27]	.513 [13.03]	1.674 [42.52]	.449 [11.40]	
	DBH-25P-F179C	702 01 25 050	585 [.14.86]	2.729 [69.32]	2.500 [64.50]	2.231 [56.67]										2.272 [57.71]
37	DCH-37P-F179	702 01 37 030	.375 [9.52]	2.729 [69.32]	2.500 [64.50]	2.231 [56.67]	.378 [9.60]	.494 [12.55]	.422 [10.72]	.060 [1.52]	.039 [.99]	2.391 [60.73]	.513 [13.03]	2.326 [59.08]	.449 [11.40]	
	DCH-37P-F179C	702 01 37 050	585 [.14.86]	2.635 [66.93]	2.406 [61.11]	2.127 [54.02]										2.178 [55.32]
50	DDH-50P-F179	702 01 50 030	.375 [9.52]	2.635 [66.93]	2.406 [61.11]	2.127 [54.02]	.378 [9.60]	.494 [12.55]	.422 [10.72]	.060 [1.52]	.039 [.99]	2.297 [58.34]	.623 [15.82]	2.218 [56.34]	.555 [14.10]	
	DDH-50P-F179C	702 01 50 050	585 [.14.86]													

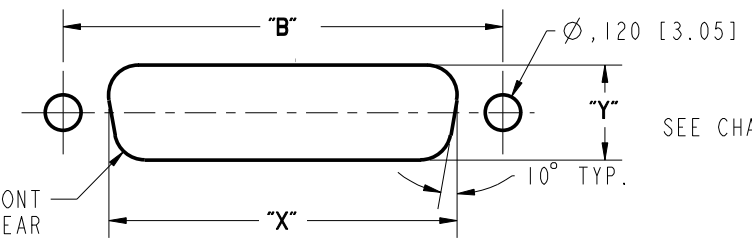

RECOMENDED MTG. HOLE LAYOUT
SEE CHART FOR FRONT AND REAR MTG. DIMENSIONS

ROHS COMPLIANT

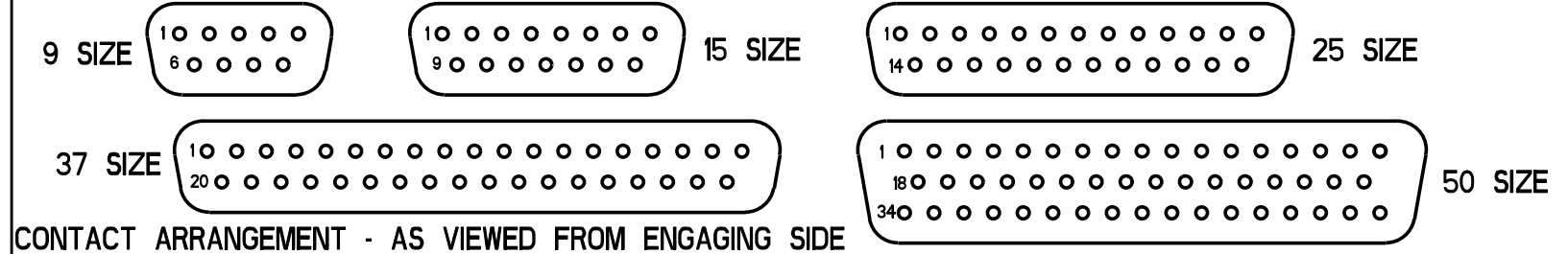

CONTACT ARRANGEMENT - AS VIEWED FROM ENGAGING SIDE

UNITS	ENGLISH	PRO/E	Cinch		MODELED BY: V. SKUZA
DO NOT SCALE DRAWING	DRAWN BY V. SKUZA	DATE 06/14/05	TITLE D-SUB WIRE WRAP .375/.585 LG. CONNECTOR PLUG ASS'Y (.120" HOLES)		1700 FINLEY RD LOMBARD, IL. 60148
	DESIGN ENGINEER A. BALI	06/14/05	MATERIAL		CONTROL SPEC NUMBER
	DESIGN ENGINEERING MGR. A. SHAH	07/09/05	MATERIAL SPEC NUMBER	FINISH	PROJECT NUMBER C14716
THIS DOCUMENT IS THE PROPERTY OF CINCH. NEITHER THIS DOCUMENT NOR ANY OF THE INFORMATION CONTAINED IN IT MAY BE DUPLICATED OR DISCLOSED WITHOUT PRIOR WRITTEN CONSENT OF CINCH.	MFG. ENGINEERING J. OCEGUERA	07/07/05	CAD FILE NUMBER DXHXXPF179	DRAWING NUMBER D*H-XXP-F179	
	QUALITY ASSURANCE A. VAZQUEZ	07/06/05	CAGE IDENT NO. SIZE 71785 B	SCALE 1:1	SHEET 1 OF 1